

# HAUSANSCHLUSS-SCHÄCHTE mit Muffe

EN 1917, DIN 4034-1, TYP 2, HAS-M

Standardausführung mit Steinzeuggerinne und PVC-KG DN 150

Artikel	DN	H/Bs mm	Ws mm	Gewicht kg/Stück	Rohr- anschluss	Euro/Stück	München	Wörth
HAS-M Haus 650	1000	650/165	150	1100	150	auf Anfrage	•	•

ab Werk München DN 1200 auf Anfrage

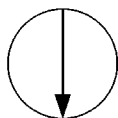
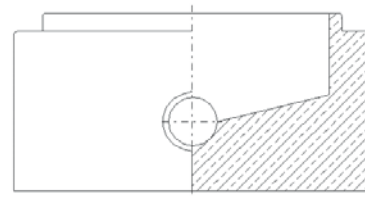

Typ 1  
180°

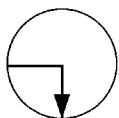

Typ 2  
270°

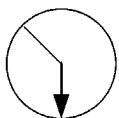

Typ 3  
225°

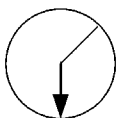

Typ 4  
135°

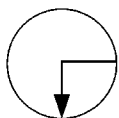

Typ 5  
90°

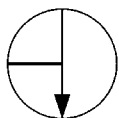

Typ 6  
270°/180°

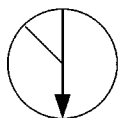

Typ 7  
225°/180°

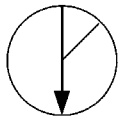

Typ 8  
180°/135°

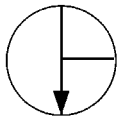

Typ 9  
180°/90°

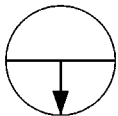

Typ 10  
270°/90°

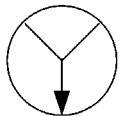

Typ 11  
225°/135°

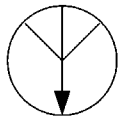

Typ 12  
225°/180°/135°

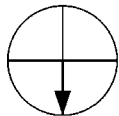

Typ 13  
270°/180°/90°

# HAUSANSCHLUSS-SCHÄCHTE mit Falz

DIN 4034, TEIL 2, HAS-F

Standardausführung mit Steinzeuggerinne und PVC-KG DN 150

Artikel	DN	H/Bs mm	Ws mm	Gewicht kg/Stück	Rohr- anschluss	Euro/Stück	München	Wörth
HAS-F Haus 500	1000	500/95	100	800	150	auf Anfrage	•	•

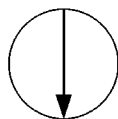
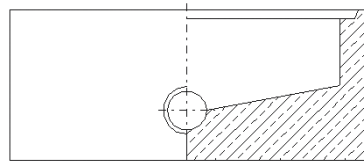

Typ 1  
180°

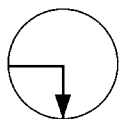

Typ 2  
270°

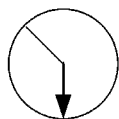

Typ 3  
225°

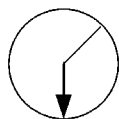

Typ 4  
135°

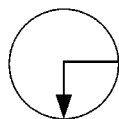

Typ 5  
90°

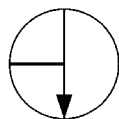

Typ 6  
270°/180°

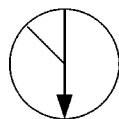

Typ 7  
225°/180°

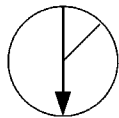

Typ 8  
180°/135°

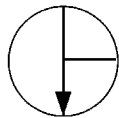

Typ 9  
180°/90°

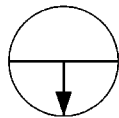

Typ 10  
270°/90°

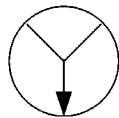

Typ 11  
225°/135°

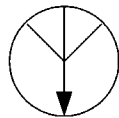

Typ 12  
225°/180°/135°

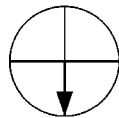

Typ 13  
270°/180°/90°